



## **BHT 320°-350°**

### **Ball Bearings for High Temperature**

The BHT 320°-350° ball bearings are designed on the dimensions of a standard bearing but with treatments of stabilisation, surface treatment, radial clearance and molybdenum grease that make them suitable for operation from -30° to +320°. Their recommended range of application is between 280° and 320°. The BHT 320° bearings are open bearings and require frequent additional lubrication with oil for high temperatures. Until the end of the 1980's, greases suitable at operating at a temperature in the absence of periodic lubrication were not available, so this product was the only solution to work in high temperatures. Such greases are now available, capable of operating up to 280° and lubrication with graphite cages for temperature up to 350°. Therefore this type of bearings now has a limited range of application in existing industrial plants. The lubrication with molybdenum disulphide grease makes the bearing vulnerable to oxidation resulting from the weather, so the shelf life is completely depending on the quality of maintenance performed. The BHT 320°-350° bearing has been produced for over 30 years and many customers have found that with the right balance in maintenance intervals achieve excellent results with a product that is objectively economic. Please note that the BHT 320°-350° bearing does not allow further greasing even with the same molybdenum disulphide grease. Our 30 years of experience has allowed us to identify almost exclusively as a cause of damage to the bearing, the added grease is incompatible even if of the same quality inside the bearing. The amount of grease used in the original design is calculated and this is what is needed to create the film of molybdenum on the raceway of the ball, and although visually seems to be a small quantity, is technically the optimal amount for operation.

#### **Technical characteristics:**

Material Steel AISI 52100 (Chrome) stabilized to the application  
Treatment of manganese phosphate coating on all steel parts  
Radial Clearance 4xC5  
Bearing running open  
Greasing with molybdenum disulphide grease

#### **Fields of application:**

Paint Ovens  
Steel Industry  
Furnaces for Ceramic Industry  
Trolley Industry, Brick Kilns



## BHT 320°-350° (MICRO Serie)

### Ball Bearings for High Temperature

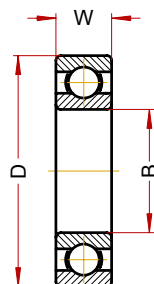
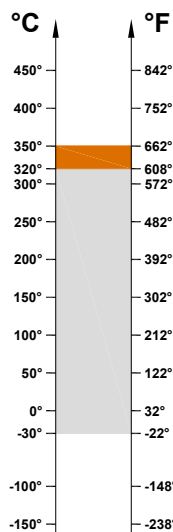

OPERATING RANGE: -30° / 320°C

ECONOMIC OPERATING RANGE: 200° / 320°C

SHORT-TIME OPERATING RANGE: 320° / 350°C

Designation	Bore (B)	Diam (D)	Widht (W)	Weight g	Speed RPM/min (*)	Static Load, kN at 350°	Static Load, kN at 20°
613/3 BHT 320°-350°	3	8	3	1.5	280	0,11	0,16
623 BHT 320°-350°	3	10	4	3	280	0,12	0,18
604 BHT 320°-350°	4	12	4	3	280	0,23	0,34
624 BHT 320°-350°	4	13	5	3	280	0,23	0,34
605 BHT 320°-350°	5	14	5	4	280	0,29	0,42
625 BHT 320°-350°	5	16	5	5	280	0,29	0,42
606 BHT 320°-350°	6	17	6	7	280	0,59	0,85
626 BHT 320°-350°	6	19	6	8	280	0,59	0,85
607 BHT 320°-350°	7	19	6	8	280	0,59	0,85
627 BHT 320°-350°	7	22	7	13	280	0,76	1,10
608 BHT 320°-350°	8	22	7	13	280	0,76	1,10
628 BHT 320°-350°	8	24	8	14	280	0,76	1,10
609 BHT 320°-350°	9	24	7	15	280	0,90	1,30
629 BHT 320°-350°	9	26	8	20	280	1,08	1,57

**OPERATING RANGE** is the correct technical range in which can be used the bearing with good operating result.

**ECONOMIC OPERATING RANGE** is the range of temperature in which you can find, according to our study experience and know-how, the better relation price - quality life-time.

**SHORT-TIME OPERATING RANGE** is the range in which the bearing can be used for few minutes but not for permanent use.

## BHT 320°-350° (61800 Serie)

### Ball Bearings for High Temperature

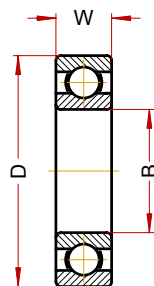
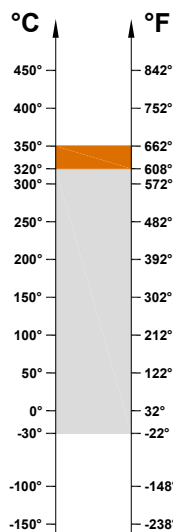

OPERATING RANGE: -30° / 320°C

ECONOMIC OPERATING RANGE: 200° / 320°C

SHORT-TIME OPERATING RANGE: 320° / 350°C

Designation	Bore (B)	Diam (D)	Widht (W)	Weight g	Speed RPM/min (*)	Static Load, kN at 350°	Static Load, kN at 20°
61800 BHT 320°-350°	10	19	5	6	282	0,37	0,53
61801 BHT 320°-350°	12	21	5	7	262	0,66	0,95
61802 BHT 320°-350°	15	24	5	7	242	0,86	1,25
61803 BHT 320°-350°	17	26	5	8	222	1	1,45
61804 BHT 320°-350°	20	32	7	18	200	1,54	2,24
61805 BHT 320°-350°	25	37	7	24	170	1,93	2,8
61806 BHT 320°-350°	30	42	7	27	130	2,31	3,35
61807 BHT 320°-350°	35	47	7	32	110	2,48	3,6
61808 BHT 320°-350°	40	52	7	35	100	2,93	4,25
61809 BHT 320°-350°	45	58	7	42	90	3,86	5,6
61810 BHT 320°-350°	50	65	7	52	85	4,34	6,3
61811 BHT 320°-350°	55	72	9	81	75	5,86	8,5
61812 BHT 320°-350°	60	78	10	105	70	7,59	11
61813 BHT 320°-350°	65	85	10	124	63	8,28	12
61814 BHT 320°-350°	70	90	10	133	60	8,62	12,5
61815 BHT 320°-350°	75	95	10	143	56	9,24	13,4

**OPERATING RANGE** is the correct technical range in which can be used the bearing with good operating result.

**ECONOMIC OPERATING RANGE** is the range of temperature in which you can find, according to our study experience and know-how, the better relation price - quality life-time.

**SHORT-TIME OPERATING RANGE** is the range in which the bearing can be used for few minutes but not for permanent use.

## BHT 320°-350° (6000 Serie)

### Ball Bearings for High Temperature

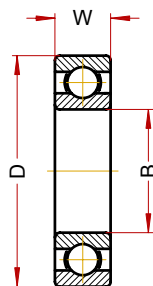
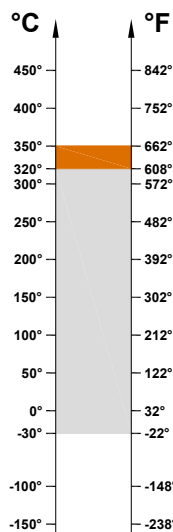

OPERATING RANGE: -30° / 320°C

ECONOMIC OPERATING RANGE: 200° / 320°C

SHORT-TIME OPERATING RANGE: 320° / 350°C

Designation	Bore (B)	Diam (D)	Width (W)	Weight g	Speed RPM/min (*)	Static Load, kN at 350°	Static Load, kN at 20°
6000 BHT 320°-350°	10	26	8	20	282	1,35	1,96
6001 BHT 320°-350°	12	28	8	25	262	1,63	2,36
6002 BHT 320°-350°	15	32	9	30	242	1,97	2,85
6003 BHT 320°-350°	17	35	10	40	222	2,24	3,25
6004 BHT 320°-350°	20	42	12	69	200	3,45	5
6005 BHT 320°-350°	25	47	12	80	170	4,04	5,85
6006 BHT 320°-350°	30	55	13	120	130	5,52	8
6007 BHT 320°-350°	35	62	14	160	110	7,17	10,4
6008 BHT 320°-350°	40	68	15	190	100	8,14	11,8
6009 BHT 320°-350°	45	75	16	250	90	9,86	14,3
6010 BHT 320°-350°	50	80	16	260	85	10,76	15,6
6011 BHT 320°-350°	55	90	18	390	75	14,62	21,2
6012 BHT 320°-350°	60	95	18	420	70	16	23,2
6013 BHT 320°-350°	65	100	18	440	63	17,24	25
6014 BHT 320°-350°	70	110	20	600	60	21,72	31,5
6015 BHT 320°-350°	75	115	20	640	50	23,45	34
6016 BHT 320°-350°	80	125	22	850	50	27,58	40
6017 BHT 320°-350°	85	130	22	890	50	29,59	42,9
6018 BHT 320°-350°	90	140	24	1150	50	34,41	49,9
6019 BHT 320°-350°	95	145	24	1200	50	37,21	53,95
6020 BHT 320°-350°	100	150	24	1250	50	37,21	53,95

**OPERATING RANGE** is the correct technical range in which can be used the bearing with good operating result.

**ECONOMIC OPERATING RANGE** is the range of temperature in which you can find, according to our study experience and know-how, the better relation price - quality life-time.

**SHORT-TIME OPERATING RANGE** is the range in which the bearing can be used for few minutes but not for permanent use.

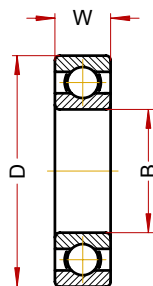
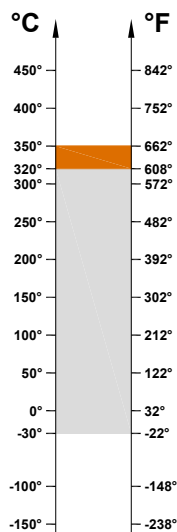
**BHT 320°-350° (6200 Serie)****Ball Bearings for High Temperature**

OPERATING RANGE: -30° / 320°C

ECONOMIC OPERATING RANGE: 200° / 320°C

SHORT-TIME OPERATING RANGE: 320° / 350°C

Designation	Bore (B)	Diam (D)	Width (W)	Weight g	Speed RPM/min (*)	Static Load, kN at 350°	Static Load, kN at 20°
6200 BHT 320°-350°	10	30	9	30	262	1,79	2,6
6201 BHT 320°-350°	12	32	10	37	242	2,14	3,1
6202 BHT 320°-350°	15	35	11	45	180	2,59	3,75
6203 BHT 320°-350°	17	40	12	65	175	3,28	4,75
6204 BHT 320°-350°	20	47	14	110	150	4,52	6,55
6205 BHT 320°-350°	25	52	15	130	140	5,52	8
6206 BHT 320°-350°	30	62	16	200	110	7,72	11,2
6207 BHT 320°-350°	35	72	17	290	100	10,55	15,3
6208 BHT 320°-350°	40	80	18	370	85	12,41	18
6209 BHT 320°-350°	45	85	19	410	80	14,06	20,4
6210 BHT 320°-350°	50	90	20	460	75	16,55	24
6211 BHT 320°-350°	55	100	21	610	67	20	29
6212 BHT 320°-350°	60	110	22	780	60	24,83	36
6213 BHT 320°-350°	65	120	23	990	53.2	28,62	41,5
6214 BHT 320°-350°	70	125	24	1040	50	30,35	44
6215 BHT 320°-350°	75	130	25	1210	50	33,79	49
6216 BHT 320°-350°	80	140	26	1400	50	37,93	55
6217 BHT 320°-350°	85	150	28	1800	50	44,14	64
6218 BHT 320°-350°	90	160	30	2150	50	50,69	73,5
6219 BHT 320°-350°	95	170	32	2500	50	56,21	81,5
6220 BHT 320°-350°	100	180	34	3150	50	64,14	93

**OPERATING RANGE** is the correct technical range in which can be used the bearing with good operating result.

**ECONOMIC OPERATING RANGE** is the range of temperature in which you can find, according to our study experience and know-how, the better relation price - quality life-time.

**SHORT-TIME OPERATING RANGE** is the range in which the bearing can be used for few minutes but not for permanent use.

## BHT 320°-350° (6300 Serie)

### Ball Bearings for High Temperature

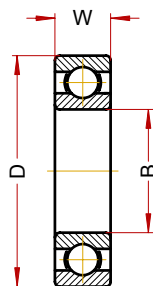
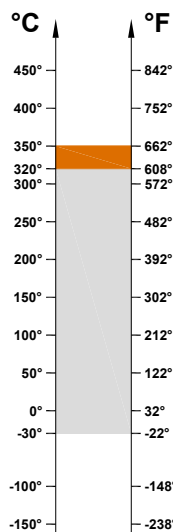

OPERATING RANGE: -30° / 320°C

ECONOMIC OPERATING RANGE: 200° / 320°C

SHORT-TIME OPERATING RANGE: 320° / 350°C

Designation	Bore (B)	Diam (D)	Width (W)	Weight g	Speed RPM/min (*)	Static Load, kN at 350°	Static Load, kN at 20°
6300 BHT 320°-350°	10	35	11	52	220	2,38	3,45
6301 BHT 320°-350°	12	37	12	60	200	2,86	4,15
6302 BHT 320°-350°	15	42	13	80	180	3,72	5,4
6303 BHT 320°-350°	17	47	14	120	160	4,52	6,55
6304 BHT 320°-350°	20	52	15	140	140	5,86	8,5
6305 BHT 320°-350°	25	62	17	225	110	7,86	11,4
6306 BHT 320°-350°	30	72	19	350	95	11,24	16,3
6307 BHT 320°-350°	35	80	21	450	85	13,10	19
6308 BHT 320°-350°	40	90	23	620	75	17,24	25
6309 BHT 320°-350°	45	100	25	830	67	22,06	32
6310 BHT 320°-350°	50	110	27	1050	60	26,21	38
6311 BHT 320°-350°	55	120	29	1350	53	32,76	47,5
6312 BHT 320°-350°	60	130	31	1700	50	35,86	52
6313 BHT 320°-350°	65	140	33	2100	50	41,38	60
6314 BHT 320°-350°	70	150	35	2500	50	46,90	68
6315 BHT 320°-350°	75	160	37	3000	50	52,76	76,5
6316 BHT 320°-350°	80	170	39	3600	50	59,66	86,5
6317 BHT 320°-350°	85	180	41	4250	50	66,55	96,5
6318 BHT 320°-350°	90	190	43	4900	50	74,48	108
6319 BHT 320°-350°	95	200	45	5650	50	81,38	118
6320 BHT 320°-350°	100	215	47	7000	50	96,55	140

**OPERATING RANGE** is the correct technical range in which can be used the bearing with good operating result.

**ECONOMIC OPERATING RANGE** is the range of temperature in which you can find, according to our study experience and know-how, the better relation price - quality life-time.

**SHORT-TIME OPERATING RANGE** is the range in which the bearing can be used for few minutes but not for permanent use.

## BHT 320°-350° (51100 Serie)

### Ball Bearings for High Temperature

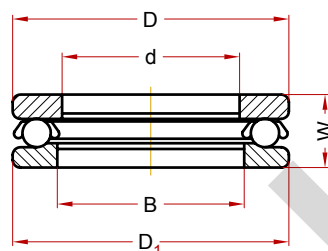
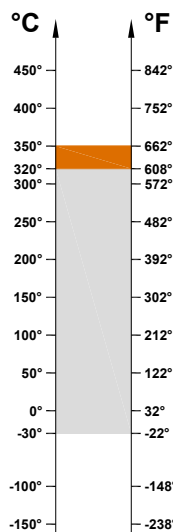

OPERATING RANGE: -30° / 320°C

ECONOMIC OPERATING RANGE: 200° / 320°C

SHORT-TIME OPERATING RANGE: 320° / 350°C

Designation	Bore (B)	Diam (D)	Widht (W)	Weight g	Speed RPM/min (*)	Static Load, kN at 350°	Static Load, kN at 20°
51100 BHT 320°-350°	10	24	9	0,02	100	10,55	15,3
51101 BHT 320°-350°	12	26	9	0,02	100	11,45	16,6
51102 BHT 320°-350°	15	28	9	0,02	100	11,59	16,8
51103 BHT 320°-350°	17	30	9	0,03	100	11,86	17,2
51104 BHT 320°-350°	20	35	9	0,04	100	15,72	22,8
51105 BHT 320°-350°	25	42	10	0,06	100	21,72	31,5
51106 BHT 320°-350°	30	47	11	0,06	100	24,83	36,0
51107 BHT 320°-350°	35	52	11	0,08	100	27,93	40,5
51108 BHT 320°-350°	40	60	13	0,12	100	37,93	55
51109 BHT 320°-350°	45	65	14	0,14	100	42,06	61
51110 BHT 320°-350°	50	70	14	0,16	100	46,90	68
51111 BHT 320°-350°	55	78	16	0,23	100	58,62	85
51112 BHT 320°-350°	60	85	17	0,30	100	70,35	102
51113 BHT 320°-350°	65	90	18	0,33	100	75,17	109
51114 BHT 320°-350°	70	95	18	0,35	100	76,55	111
51115 BHT 320°-350°	75	100	19	0,40	100	100	145

**OPERATING RANGE** is the correct technical range in which can be used the bearing with good operating result.

**ECONOMIC OPERATING RANGE** is the range of temperature in which you can find, according to our study experience and know-how, the better relation price - quality life-time.

**SHORT-TIME OPERATING RANGE** is the range in which the bearing can be used for few minutes but not for permanent use.

## BHT 320°-350° (51200 Serie)

### Ball Bearings for High Temperature

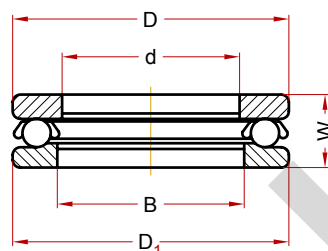
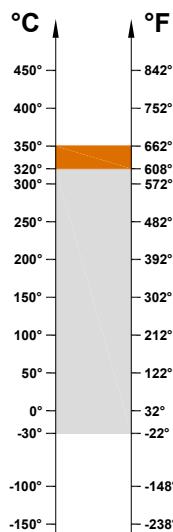

OPERATING RANGE: -30° / 320°C

ECONOMIC OPERATING RANGE: 200° / 320°C

SHORT-TIME OPERATING RANGE: 320° / 350°C

Designation	Bore (B)	Diam (D)	Widht (W)	Weight g	Speed RPM/min (*)	Static Load, kN at 350°	Static Load, kN at 20°
51200 BHT 320°-350°	10	26	11	0,03	100	12,83	18,6
51201 BHT 320°-350°	12	28	11	0,03	100	14,34	20,8
51202 BHT 320°-350°	15	32	12	0,05	100	18,62	27
51203 BHT 320°-350°	17	35	12	0,05	100	20,69	30
51204 BHT 320°-350°	20	40	14	0,08	100	28,28	41
51205 BHT 320°-350°	25	47	15	0,11	100	37,93	55
51206 BHT 320°-350°	30	52	16	0,13	100	40,69	59
51207 BHT 320°-350°	35	62	18	0,22	100	50,69	73,5
51208 BHT 320°-350°	40	68	19	0,28	100	73,10	106
51209 BHT 320°-350°	45	73	20	0,30	100	75,17	109
51210 BHT 320°-350°	50	78	22	0,37	100	80	116
51211 BHT 320°-350°	55	90	25	0,59	100	101,38	147
51212 BHT 320°-350°	60	95	26	0,65	100	103,45	150
51213 BHT 320°-350°	65	100	27	0,78	100	113,10	164
51214 BHT 320°-350°	70	105	27	0,79	100	118,62	172
51215 BHT 320°-350°	75	110	27	0,83	100	126,90	184

**OPERATING RANGE** is the correct technical range in which can be used the bearing with good operating result.

**ECONOMIC OPERATING RANGE** is the range of temperature in which you can find, according to our study experience and know-how, the better relation price - quality life-time.

**SHORT-TIME OPERATING RANGE** is the range in which the bearing can be used for few minutes but not for permanent use.

## BHT 320°-350° (51300 Serie)

### Ball Bearings for High Temperature

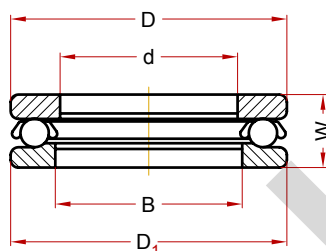
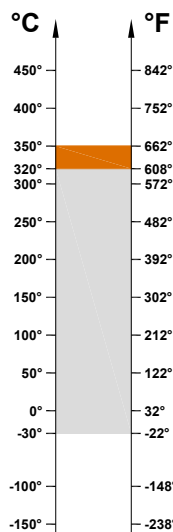

OPERATING RANGE: -30° / 320°C

ECONOMIC OPERATING RANGE: 200° / 320°C

SHORT-TIME OPERATING RANGE: 320° / 350°C

Designation	Bore (B)	Diam (D)	Width (W)	Weight g	Speed RPM/min (*)	Static Load, kN at 350°	Static Load, kN at 20°
51305 BHT 320°-350°	25	52	18	0,17	100	41,38	60
51306 BHT 320°-350°	30	60	21	0,26	100	48,97	71
51307 BHT 320°-350°	35	68	24	0,38	100	66,21	96
51308 BHT 320°-350°	40	78	26	0,53	100	84,13	122
51309 BHT 320°-350°	45	85	28	0,66	100	105,52	153
51310 BHT 320°-350°	50	95	31	0,94	100	131,03	190
51311 BHT 320°-350°	55	105	35	1,30	100	155,17	225
51312 BHT 320°-350°	60	110	35	1,35	100	158,62	230
51313 BHT 320°-350°	65	115	36	1,50	100	165,51	240
51314 BHT 320°-350°	70	125	40	2,00	100	221,38	321
51315 BHT 320°-350°	75	135	44	2,60	100	269,66	391

**OPERATING RANGE** is the correct technical range in which can be used the bearing with good operating result.

**ECONOMIC OPERATING RANGE** is the range of temperature in which you can find, according to our study experience and know-how, the better relation price - quality life-time.

**SHORT-TIME OPERATING RANGE** is the range in which the bearing can be used for few minutes but not for permanent use.