

INSOCOAT tapered roller bearings for suspension tubes

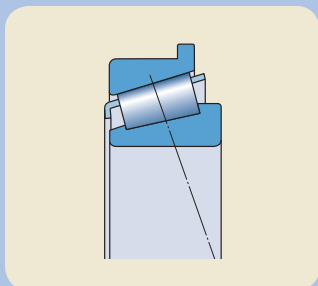

Customer benefits

- two functions in one solution:
 - bearing function
 - electrical insulation
- premature bearing failures caused by stray electric currents are eliminated
- increased machine uptime
- reduced maintenance costs
- economical solution
- increased reliability

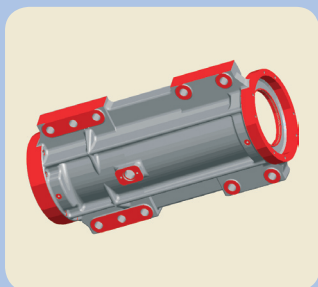
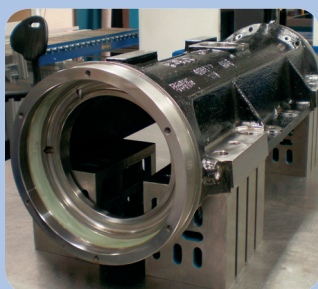

INSOCOAT bearings have been developed to prevent damaging current from passing through the bearing. INSOCOAT bearings are a very cost-effective solution compared with other insulation methods. By integrating the insulating properties into the bearing, INSOCOAT bearings can improve reliability and increase equipment uptime by virtually eliminating the problem of electrical erosion.

INSOCOAT tapered roller bearings for suspension tubes in railway vehicles have an electrically insulating coating on the external surfaces of the outer ring.

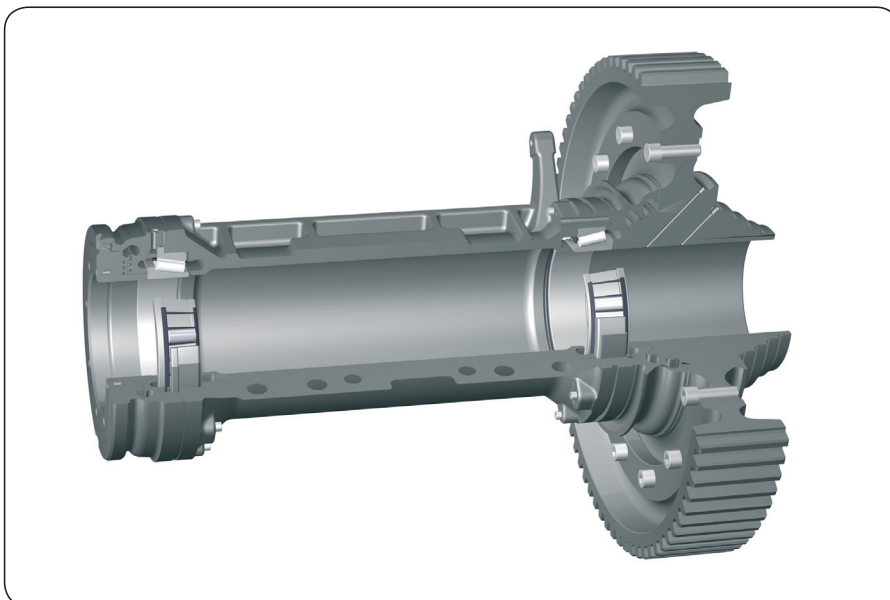

Features

- Reliable electrical insulation
- Outstanding coating quality
- Easy mounting
- High load carrying capacity
- Tapered roller bearings provide a stiff and accurate arrangement
- Optimized internal design

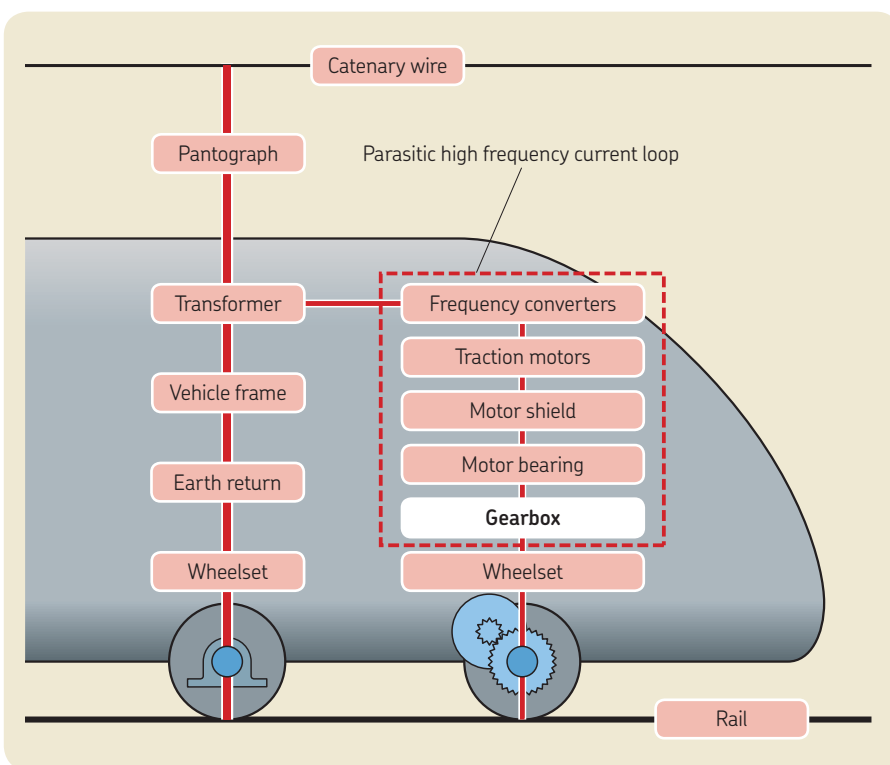

Principle of electric current flow through the gearbox and the suspension tube

© SKF and INSOCOAT are registered trademarks of the SKF Group.

© SKF Group 2012

The contents of this publication are the copyright of the publisher and may not be reproduced (even extracts) unless prior written permission is granted. Every care has been taken to ensure the accuracy of the information contained in this publication but no liability can be accepted for any loss or damage whether direct, indirect or consequential arising out of the use of the information contained herein.

PUB 42/P2 13134 EN · September 2012

Printed in Austria on environmentally friendly paper.

